



CONTACTOR RELAY, 6NO+2NC,  
W. PERMANENT. JOINTED AUXILIARY SWITCH BLOCK  
24V DC,  
SIZE S00, CAGE CLAMP CONNECTION,  
SIZE S00

### General technical data:

<b>product brand name</b>		SIRIUS
<b>Product designation</b>		contactor relay
<b>Size of the contactor</b>		S00
<b>Protection class IP / on the front</b>		IP20
<b>Degree of pollution</b>		3
<b>Insulation voltage / with degree of pollution 3 / rated value</b>	V	690
<b>Installation altitude / at a height over sea level / maximum</b>	m	2,000
<b>Ambient temperature</b>		
• during transport	°C	-55 ... +80
• during storage	°C	-55 ... +80
• during operating	°C	-25 ... +60
<b>Contact reliability</b>		one incorrect switching operation of 100 million switching operations (17 V, 1 mA)
<b>Resistance against shock</b>		10g / 5 ms and 5g / 10 ms
<b>Impulse voltage resistance / rated value</b>	kV	6
<b>Reference code</b>		
• according to DIN EN 61346-2		K
• according to DIN 40719 extended according to IEC 204-2 / according to IEC 750		K
• according to DIN EN 81346-2		K

<b>Mechanical operating cycles as operating time</b>			10,000,000
• of the contactor / typical			
<b>Control circuit/ Control:</b>			
<b>Voltage type / of control feed voltage</b>			DC
<b>Control supply voltage</b>			
• for DC / rated value	V		24
<b>Operating range factor control supply voltage rated value / of the magnet coil</b>			
• for DC			0.8 ... 1.1
<b>Pull-in power / of the solenoid / for DC</b>	W		3.2
<b>Holding power / of the solenoid / for DC</b>	W		3.2
<b>Auxiliary circuit:</b>			
<b>Product extension / auxiliary switch</b>			No
<b>Identification number and letter for switching elements</b>			62 E
<b>Contact reliability / of the auxiliary contacts</b>			1 faulty switching per 100 million (17 V, 1 mA)
<b>Number of NC contacts / for auxiliary contacts</b>			2
• delayed switching			0
• instantaneous switching			2
• asynchronous switching			0
• lagging switching			0
<b>Number of NO contacts / for auxiliary contacts</b>			6
• instantaneous switching			6
• delayed switching			0
• asynchronous switching			0
• leading switching			0
<b>Number of changeover contacts</b>			
• for auxiliary contacts			0
• of the auxiliary contacts / instantaneous switching			0
<b>Operating current</b>			
• at AC-12 / maximum	A		10
• at AC-15			
• at 230 V / rated value	A		6
• at 400 V / rated value	A		3
• at 500 V / rated value	A		2
• at 690 V / rated value	A		1
<b>Operating current / with 1 current path</b>			
• at DC-12			
• at 24 V / rated value	A		10
• at 110 V / rated value	A		3

- at 220 V / rated value
- at DC-13
- at 24 V / rated value
- at 110 V / rated value
- at 220 V / rated value

A	1
A	10
A	1
A	0.27

#### Short-circuit:

**Design of the fuse link / for short-circuit protection of the auxiliary switch / required**

fuse gL/gG: 10 A

#### Installation/ mounting/ dimensions:

**mounting position**

+/-180° rotation possible on vertical mounting surface; can be tilted forward and backward by +/- 22.5° on vertical mounting surface

**Mounting type**

screw and snap-on mounting

**Width**

mm 45

**Height**

mm 60

**Depth**

mm 114

**Distance, to be maintained, to the ranks assembly / sideways**

mm 0

#### Connections/ terminals:

**Design of the electrical connection / for auxiliary and control current circuit**

Cage Clamp terminals

**Type of the connectable conductor cross-section**

- for auxiliary contacts
  - solid
  - finely stranded
    - with conductor end processing
    - without conductor final cutting
- for AWG conductors / for auxiliary contacts

2x (0.25 ... 2.5 mm<sup>2</sup>)

2x (0.25 ... 1.5 mm<sup>2</sup>)

2x (0.25 ... 2.5 mm<sup>2</sup>)

2x (24 ... 14)

#### Certificates/ approvals:

**Verification of suitability**

CSA / UL / CCC / GL / LRS / BV / DNV / RMRS / RINA

**General Product Approval**

**Functional Safety / Safety of Machinery**

**Declaration of Conformity**



[Type Examination](#)



**Test Certificates**

**Shipping Approval**

[Special Test Certificate](#)

[Type Test Certificates/Test Report](#)



**other**

[other](#)

[Environmental Confirmations](#)

**Safety related data:**

**Proportion of dangerous failures**

- with high demand rate / according to SN 31920
- with low demand rate / according to SN 31920

%	75
%	40

**Protection against electrical shock**

finger-safe

**T1 value / for proof test interval or service life / according to IEC 61508**

a	20
---	----

**B10 value / with high demand rate**

- according to SN 31920
- note

1,000,000
With 0.3 x Ie

**Further information:**

**Information- and Downloadcenter (Catalogs, Brochures,...)**

<http://www.siemens.com/industrial-controls/catalogs>

**Industry Mall (Online ordering system)**

<https://mall.industry.siemens.com/>

**Cax online generator**

<http://www.siemens.com/cax>

**Service&Support (Manuals, Certificates, Characteristics, FAQs,...)**

<http://support.automation.siemens.com/WW/view/en/3RH1262-2BB40/all>

**Image database (product images, 2D dimension drawings, 3D models, device circuit diagrams, ...)**

[http://www.automation.siemens.com/bilddb/cax\\_en.aspx?mlfb=3RH1262-2BB40](http://www.automation.siemens.com/bilddb/cax_en.aspx?mlfb=3RH1262-2BB40)

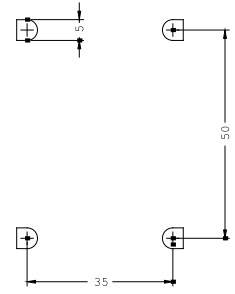
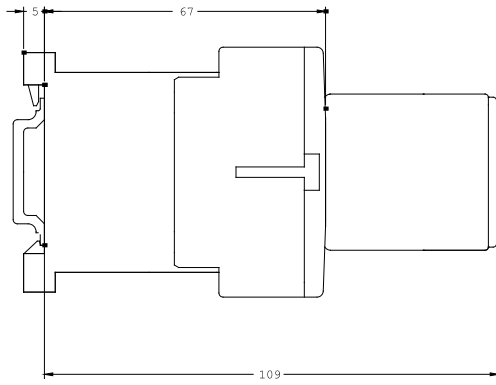
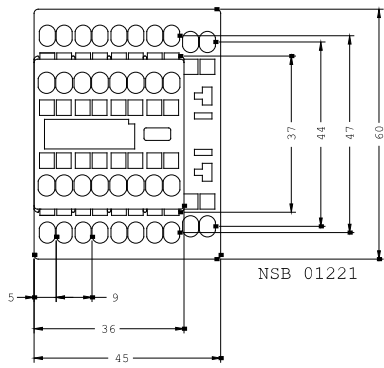

last change:

Jul 21, 2014