



Main

Range of product	Telemecanique Photoelectric sensors XU
Accessory / separate part categor	Mounting and fixing accessory
Accessory / separate part type	Fixing bracket
Product or component type	Fixing bracket
Operating angle	90 °
Accessory / separate part destination	Sensor ∅ 18 mm
Material	Stainless steel



Complementary

Product compatibility	XU.
Net weight	0.045 Kg

Packing Units

Unit Type of Package 1	PCE
Number of Units in Package 1	1
Package 1 Height	3.600 Cm
Package 1 Width	5.000 Cm
Package 1 Length	2.900 Cm
Package 1 Weight	38.000 G
Unit Type of Package 2	S01
Number of Units in Package 2	100
Package 2 Height	15 Cm
Package 2 Width	15 Cm
Package 2 Length	40 Cm
Package 2 Weight	3.946 Kg

Offer Sustainability

Sustainable offer status	Green Premium product
REACH Regulation	 REACH Declaration
EU RoHS Directive	Pro-active compliance (Product out of EU RoHS legal scope)
Mercury free	Yes
RoHS exemption information	 Yes
California proposition 65	WARNING: This product can expose you to chemicals including: Diisononyl phthalate (DINP), which is known to the State of California to cause cancer, and Di-isodecyl phthalate (DIDP), which is known to the State of California to cause birth defects or other reproductive harm. For more information go to www.P65Warnings.ca.gov

Contractual warranty

Warranty	18 months
----------	-----------

Dimensions

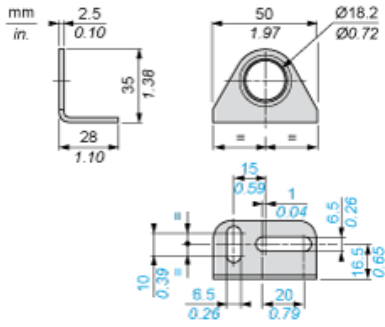

Product Life Status : Commercialised